

# WEB MANUAL

EP 4



[www.hertzaudiovideo.com](http://www.hertzaudiovideo.com)

**HERTZ**  
The Sound Experience



**INPUTS**

**PRE IN Mono (2 Ch Mode)**

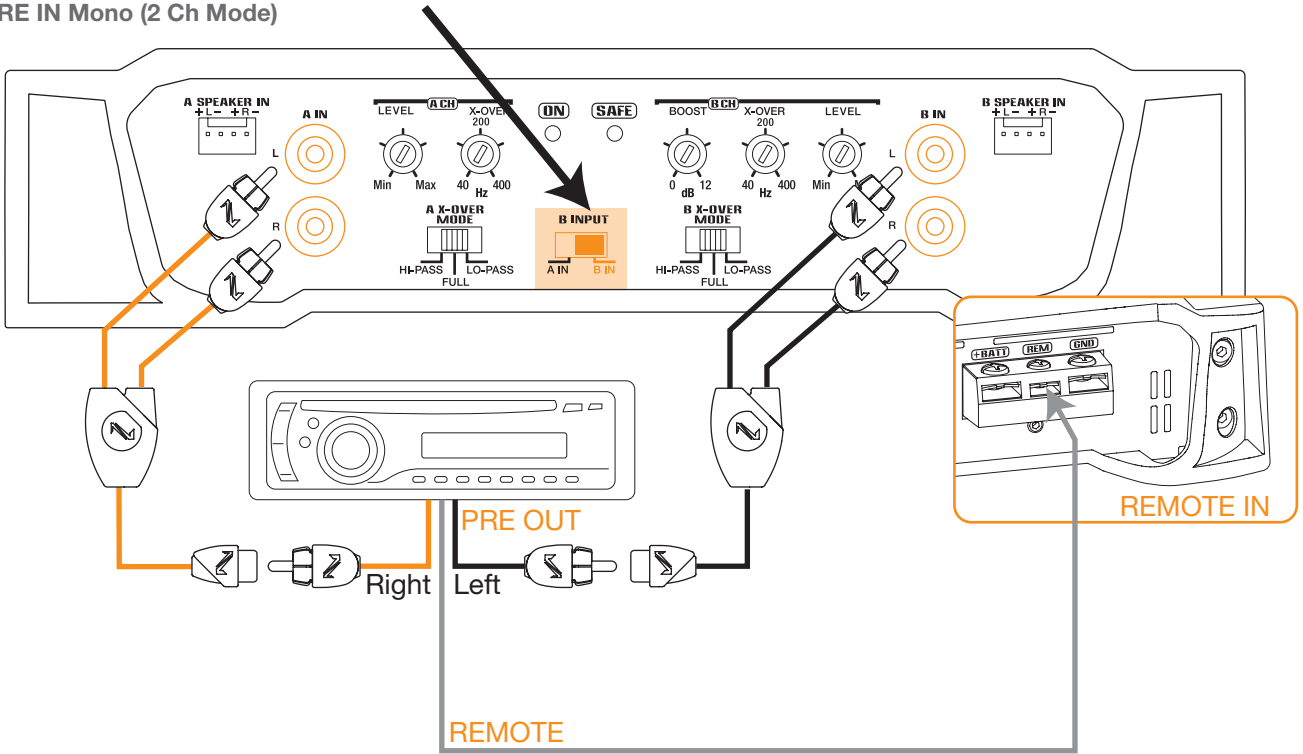

**INPUTS**

**SPEAKER IN Mono (2Ch Mode)**

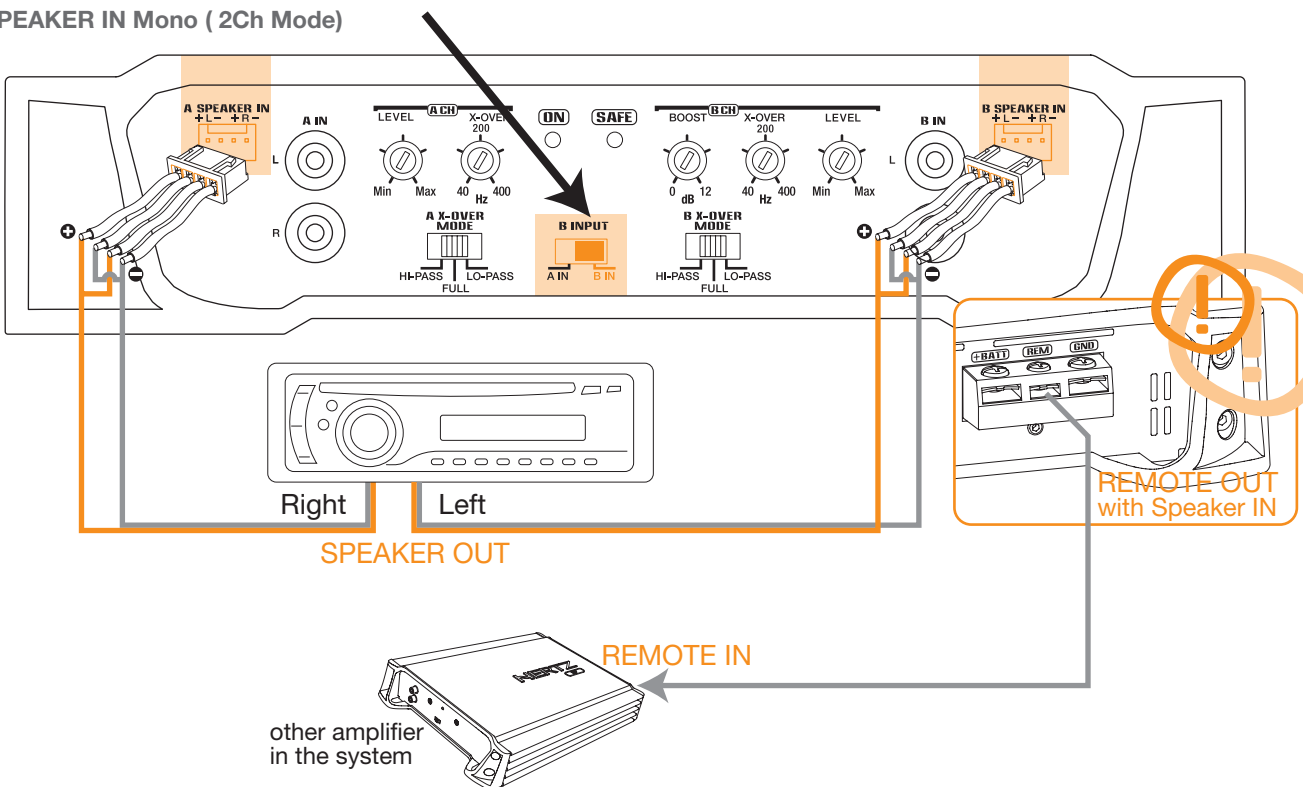

**OUTPUTS**

**4 Channels Mode - Front / Rear**

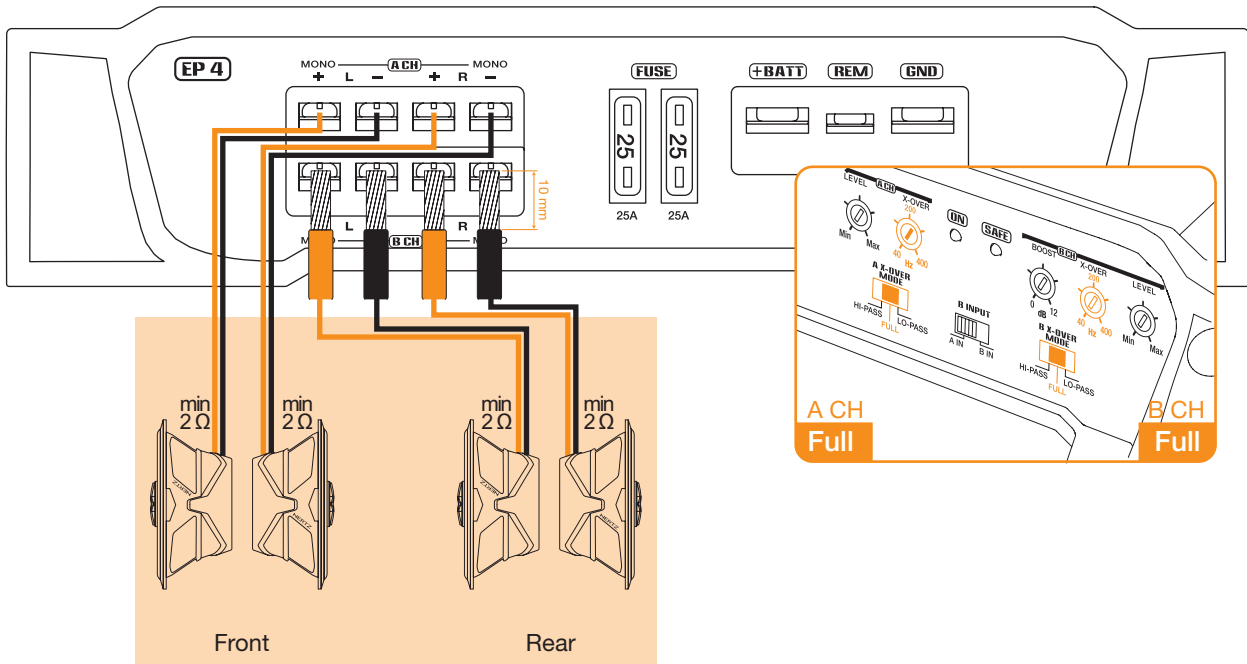

**OUTPUTS**

**4 Channels Mode - Multichannel**

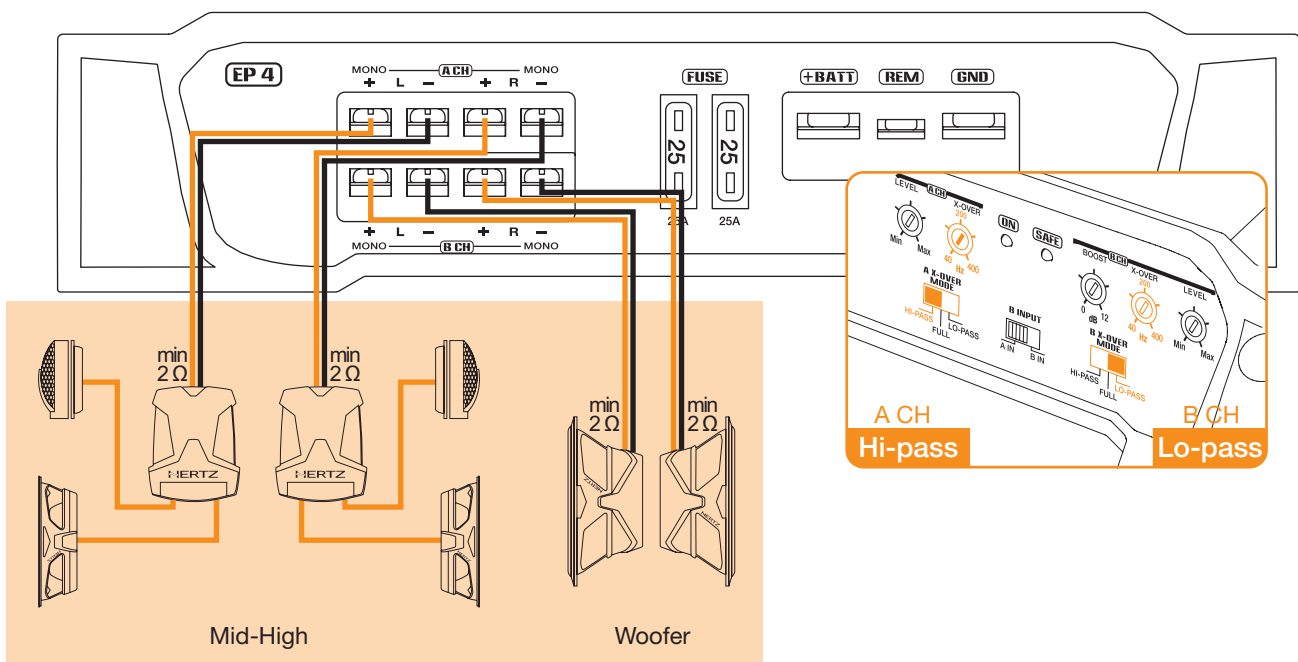

**OUTPUTS**

**3 Channels Mode - Front-Sub**

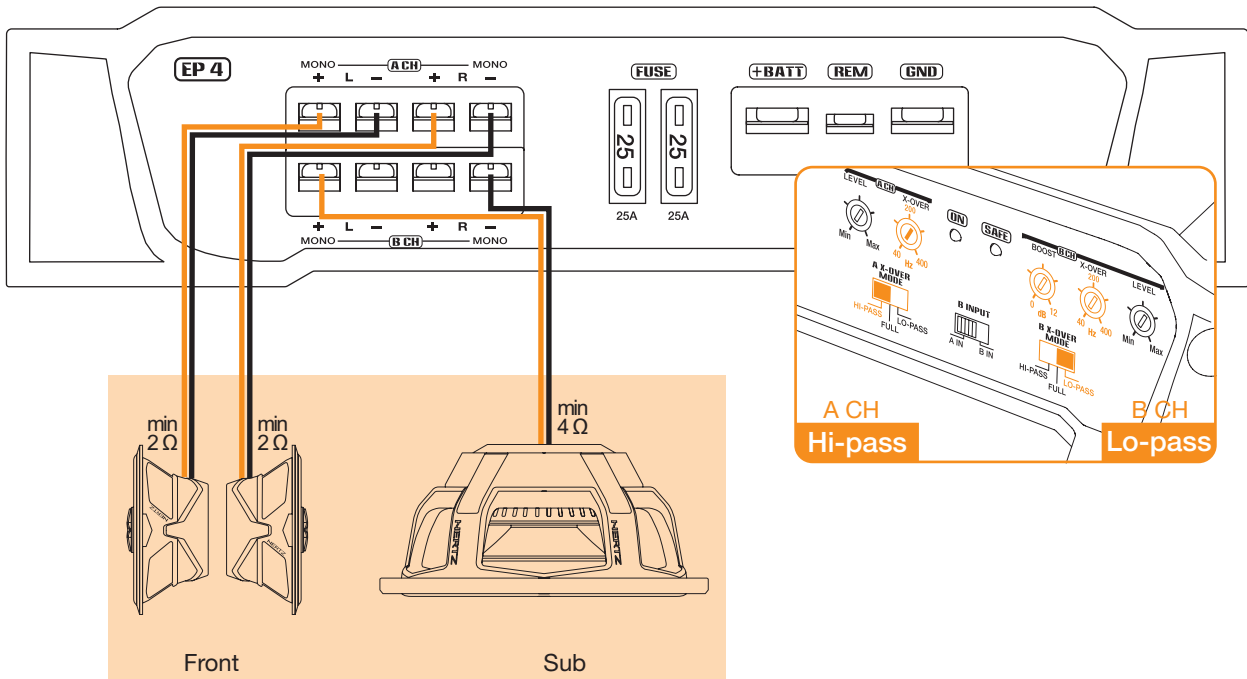

**OUTPUTS**

**2 Channels Mode - Front**

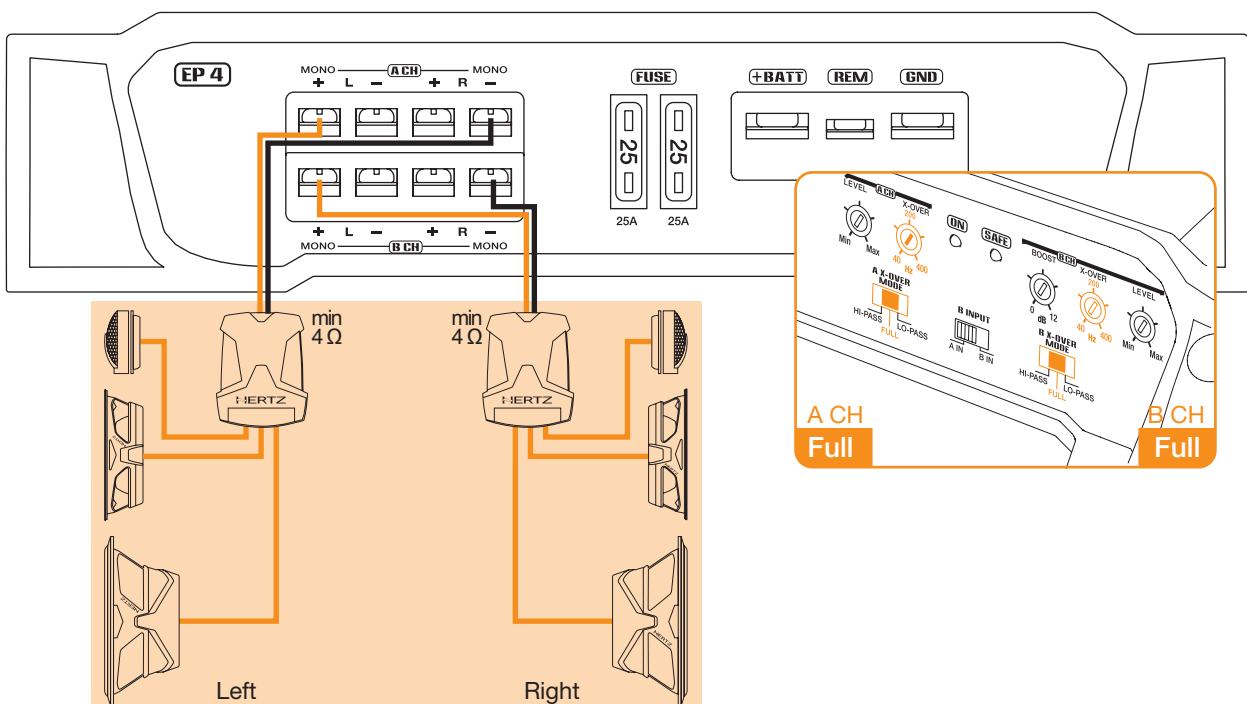



OUTPUTS

2 Channels Mode - Sub

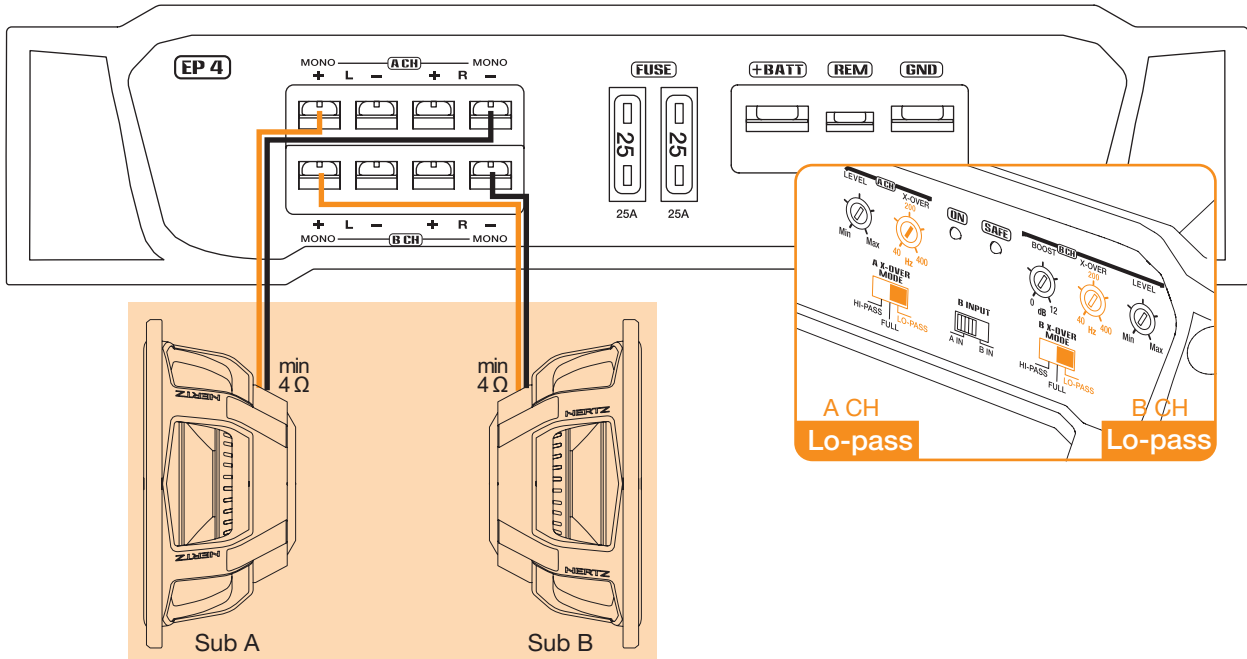

**CONFIGURATION**

**Input configuration**

| Mode                         | Input | A Ch                                      | B Ch                                      |
|------------------------------|-------|---|---|
| 4 Ch                         |       | A IN                                      | A IN                                      |
| 4 Ch                         |       | A IN                                      | B IN                                      |
| 3 Ch<br>A= stereo<br>B= mono |       | A IN                                      | Apply same L&R signal using RCA Y-adaptor |
| 2 Ch                         |       | Apply same L&R signal using RCA Y-adaptor | Apply same L&R signal using RCA Y-adaptor |

**Filter configuration**

| Config. | A Ch | B Ch |
|---------|------|------|
| 1       |      |      |
| 2       |      |      |
| 3       |      |      |
| 4       |      |      |
| 5       |      |      |
| 6       |      |      |
| 7       |      |      |
| 8       |      |      |
| 9       |      |      |

**TECHNICAL SPECIFICATIONS**

**EP4**

| Power Supply                                   |                 |
|--|-----------------|
| Voltage  | 11±15 VDC       |
| Minimum idling current                         | 1 A             |
| Idling current when off                        | 0.02 mA         |
| Consumption @ 2Ω; 14.4 VDC (MAX Musical Power) | 28 A            |
| Remote IN Voltage                              | 6±15 VDC (1 mA) |
| Internal fuse                                  | 2 x 25 A        |

| Amplifier stage                       |                                |
|---------------------------------------|--------------------------------|
| Bandwidth (-3dB)                      | 7÷60k Hz                       |
| Distortion - THD (1 kHz @ 4 Ω)        | 0.08%                          |
| S/N Ration (weighted A @ 1 V)         | 98 dB                          |
| Damping factor (1 kHz @ 4 Ω)          | 130                            |
| Input sensitive (PRE IN)              | 0.3÷5 V                        |
| Input sensitive (Speaker IN)          | 1.4±24 V                       |
| Input impedance (PRE IN)              | 15 kΩ                          |
| Input impedance (Speaker IN)          | 5 kΩ                           |
| Load impedance (MIN)                  |                                |
| 4 Ch                                  | 2Ω                             |
| 3 Ch                                  | 2 x 2Ω + 1 x 4Ω                |
| 2 Ch                                  | 4Ω                             |
| Output Power (RMS) @ 14.4 VDC; THD 1% |                                |
| 4 Ch                                  | 60 W x 4 (4Ω)                  |
| 4 Ch                                  | 95 W x 4 (2Ω)                  |
| 3 Ch                                  | 60 W x 2 (4Ω) + 190 W x 1 (4Ω) |
| 3 Ch                                  | 95 W x 2 (2Ω) + 190 W x 1 (4Ω) |
| 2 Ch                                  | 190 W x 2 (4Ω)                 |

| Inputs / Outputs / Filters |  |
|----------------------------|--|
| Input                      | PRE / Speaker                                |
| AMP Filter                 |  |
| A Ch                       | Full / Hi-pass / Lo-pass 40÷400Hz@12dB/Oct.  |
| B Ch                       | Full / Hi-pass / Lo-pass 40÷400Hz@12dB/Oct.  |
| Bass Boost                 | B Channels 0 ÷ +12dB @ 45 Hz                 |
| Other Functions            |  |
| ART                        | Automatic Remote Turn-On/Off with Speaker-In |

| Size         |  |
|--------------|--|
| B x L x H mm | 240 x 350 x 54   |
| inches       | 9 <sup>15/32</sup> x 13 <sup>25/32</sup> x 2 <sup>5/32</sup> |
| Weight kg    | 3,56   |
| lb           | 7.85   |